

alca

Shower
drains



8 May 2025

www.alcadrain.com

Description	Ref. nr.	Bar code
APZ19 SIMPLE	APZ19-550	8595580583149
	APZ19-650	8595580583156

Shower drain with an edge for two-sided grid

Application

- For indoor use
- For drainage of floor-level showers
- For installation into open spaces or near the wall of the shower area
- For wheelchair access
- For embedding tiles or waterproof wood to the thickness of 8 mm

Features

- They are made of highly durable plastic that resists frost and chemistry
- Adjustable plastic anchoring legs 0–35 mm allowing fast and convenient installation, including the precise setting of the required level
- Secure connection to the construction waterproofing system
- Combined odour trap provides protection against odour from the sewage even after the water dries out from the waste
- Mechanically cleanable trap up to the waste pipe
- Grid is included in packaging
- Material: polypropylene filled with talc resistant to mechanical, chemical and thermal damage

Scope of supply

- Linear shower drain
- Two-sided grid DOUBLE (full grid or grid for embedding tiles)
- Fixation set: screw Ø4,2×38 – 4 pcs, dowel Ø8 – 4 pcs
- Self-adhesive waterproofing tape
- Combined odour trap SMART
- Height adjustable feet 2 pcs

Technical specifications

- Odor trap combined with a water seal 25 mm
- Flow of the inlet grid 24 l/min
- Waste outlet diameter 1 ½
- Minimum thickness of concrete 62 mm
- Total installation height 75 – 110 mm
- Load class H15 150

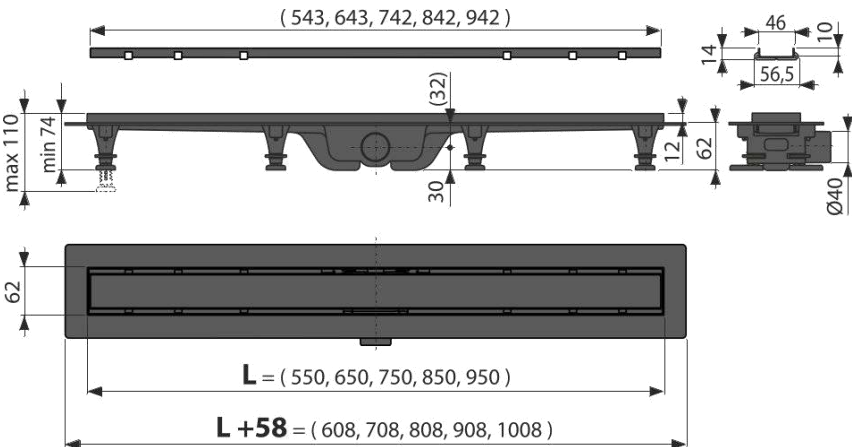

Description	Ref. nr.	Bar code
APZ2012-OPTION9- Optimal	APZ2012-OPTION9-550	
Shower drain with an edge for two-sided grid		
Flow of the inlet grid 50 l/min		
Aplication For wheelchair access For drainage of floor-level showers For installation into open spaces or near the wall of the shower area For indoor use	APZ2012-OPTION9-650	8595580577698
Features Secure connection to the construction waterproofing system Material: polypropylene filled with talc resistant to mechanical, chemical and thermal damage Mechanically cleanable trap up to the waste pipe Self-adhesive tape for quality waterproofing Installation height from 77 mm Wet odour trap with swivel elbow Adjustable plastic anchor legs allowing fast and convenient installation, including the precise setting of the required level High resistance against chemicals	APZ2012-OPTION9-750	
Scope of supply Fixing hardware for anchoring the adjustable legs: screw 4.2×9.5 – 8 pcs Two-sided grid OPTION Self-adhesive waterproofing tape Strainer to capture the dirt Wet odour trap Height adjustable feet Linear shower drain	APZ2012-OPTION9-850	
Technical specifications Total installation height 77-110 mm Minimum thickness of concrete 85 mm Resistance of odour trap against the pressure 710 Pa Waste outlet diameter 40 mm Flow of the inlet grid 40 l/min Load class K3 300 kg Odor trap combined with a water seal 31 mm		



APZ2012-OPTION9-650

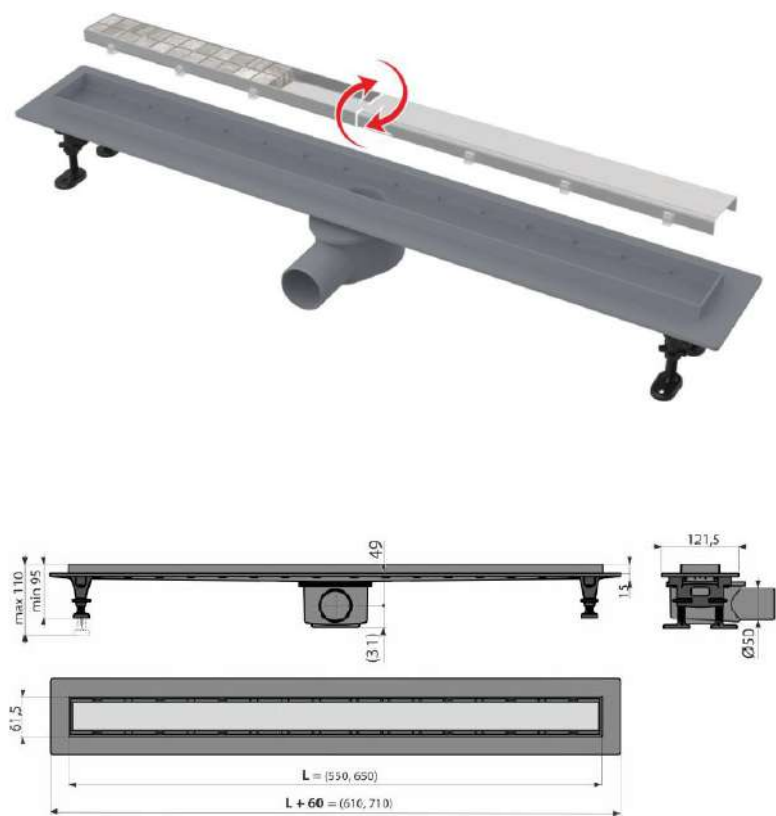

Description	Ref. nr.	Bar code	
APZ19BLACK Simple BLACK-MATT SHOWER DRAIN WITH AN EDGE FOR TWO-SIDED GRID For indoor use. For drainage of floor-level showers. For installation into open spaces or near the wall of the shower area. For wheelchair access. For embedding tiles or water-proof wood to the thickness of 8 mm.	APZ19BLACK-550	8595580583378	1 PCS
	APZ19BLACK-650	8595580583385	1 PCS



Description	Ref. nr.	Bar code	
APZ10BLACK-BRASS Simple Plastic linear shower drain with an edge for perforated grids, black brass Flow rate 28L/min.	APZ10BLACK-550BRASS	8595580574888	
	APZ10BLACK-650BRASS	8595580574840	

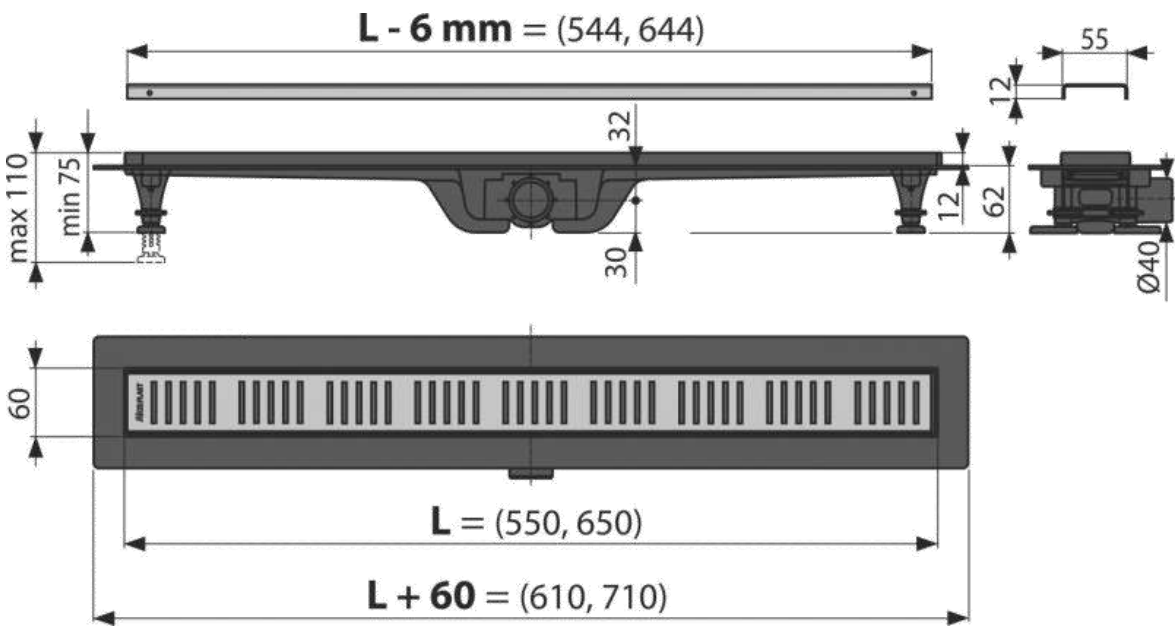

Description	Ref. nr.	Bar code
APZ13 DOUBLE9 Stainless steel linear shower drain + grid TILE or + grid SOLID	APZ13-DOUBLE9-550	8595580571443
	APZ13-DOUBLE9-650	8595580571450
	APZ13-DOUBLE9-750	8595580562724
	APZ13-DOUBLE9-850	8595580562731
	APZ13-DOUBLE9-950	8595580562748

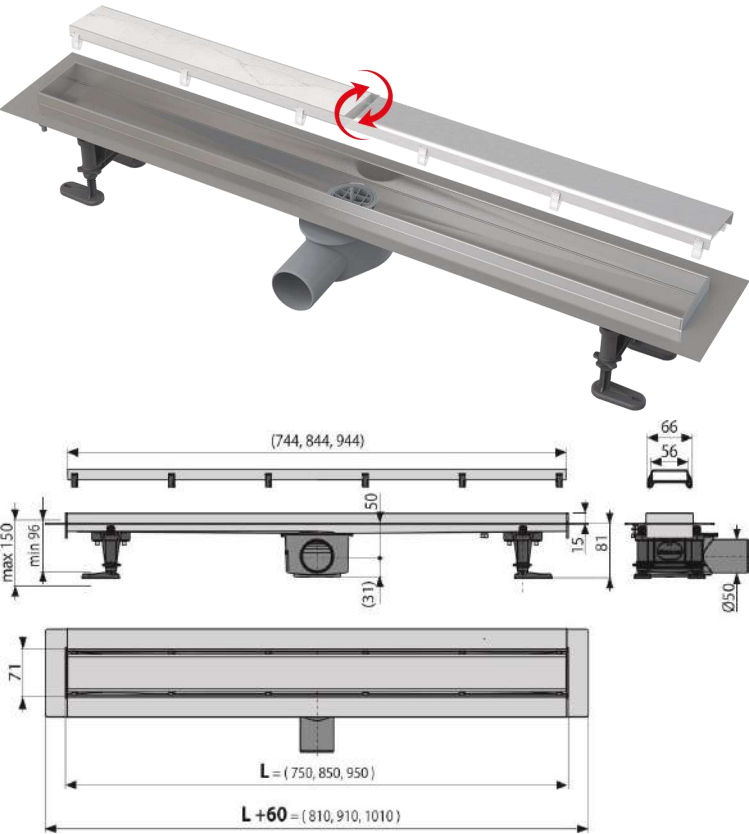

APZ13-DOUBLE9 Fit and Go

Shower drain
(550, 650, 750, 850, 950 mm)



Spare parts for APZ13 Modular		
	combined odour trap for apz-s9 for drain APZ13 σιφόνι smart για υγρή και ξηρή παγίδα μυρωδιάς!	P144 8595580562304
	Spacer for double grid APZ13-DOUBLE9	Z1431-ND
	Hair trap for APZ13	Z1022-ND

Description	Ref. nr.	Bar code	
APZ15 MARBLE shower drain without edge with grid for embedding tiles	APZ15-550	8595580565534	
	APZ15-650	8595580565541	
	APZ15-750	8595580565558	

APZ15 MARBLE

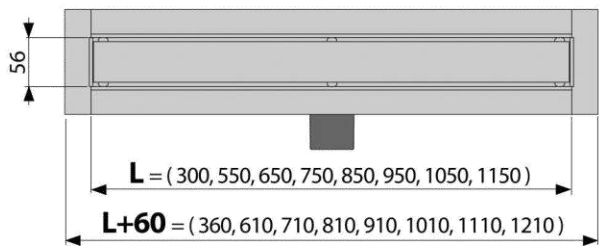
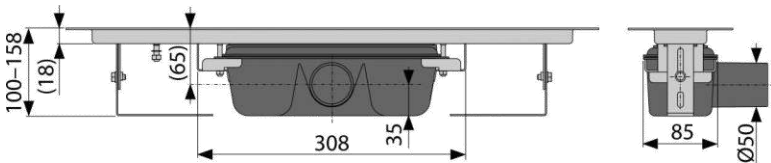

MINIMALISTIC DESIGN
The new construction of the shower drain and grid without frame merges the floor surface in the bathroom



INSTALLATION WITHOUT LIMIT
The grid allows application of tiles of any thickness



FOR LARGE FORMAT BOARDS FROM NATURAL STONE
Template for cutting floor coverings is part of the packing



ALL IN PACKAGE



APV140

Floor drain

130×130 mm side outlet, two-sided stainless steel grid, wet odour trap

For the interior, where will be frequent use associated with the regular water runoff into the floor drain (bathrooms)

For drainage of floor level showers

For wheelchair access

Flow rate 48 l/min

Odour trap 50 mm

Resistance of odour trap against the pressure 540 Pa

Load class K3 300 kg

Waste pipe diameter 50 mm

Total installation height 108 – 162 mm

APV140

8595539269097

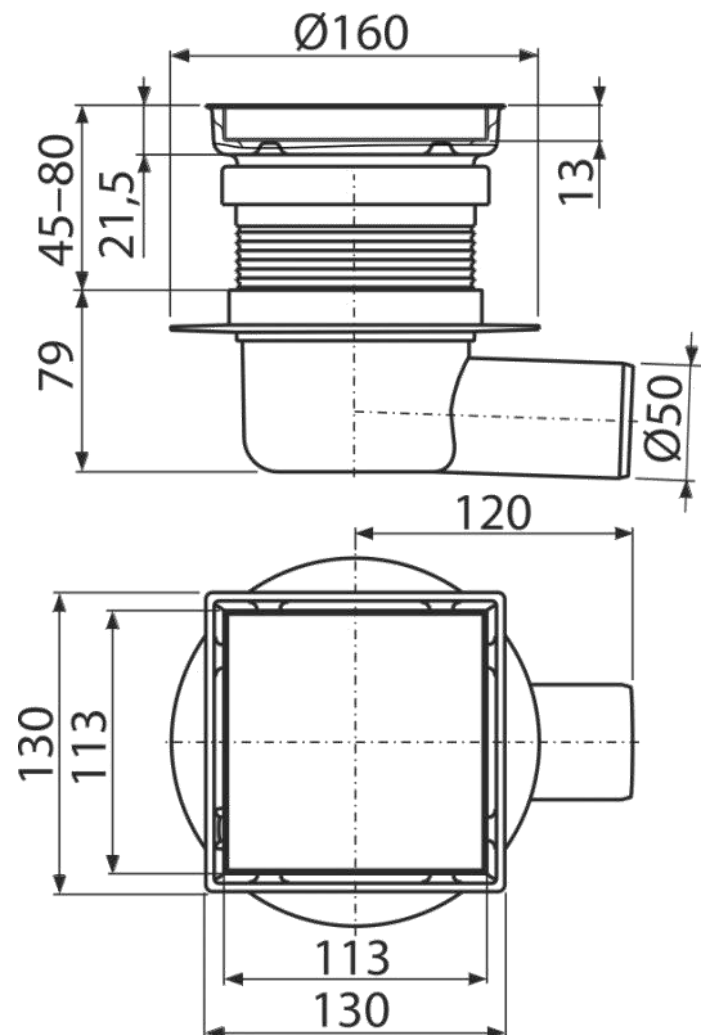

APV3444

8595580518523

**floor drain for outdoor & interior
150×150/50/75 mm side outlet, stainless steel grid,
stainless steel flange and collar-2nd level insulation,
wet and dry odour trap.**

The flow of the inlet grid (wet odour trap) 46 l/min

The flow of the inlet grid (dry odour trap) 62 l/min

Wet odour trap 51 mm. Resistance of odour trap against the pressure

480 Pa. Load class K3 300 kg. Waste pipe diameter 50 – 75 mm

Total installation height 79 – 189 mm.

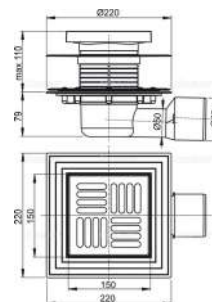

APV1311

8595580518455

**Floor drain 105×105/50 mm side outlet, stainless steel grid, wet
odour trap**

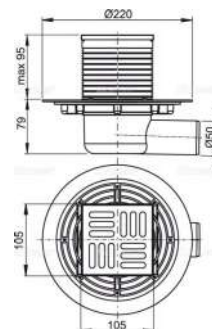

APV5411

8595580520762

**Interior floor drain 150 × 150/50
side outlet, stainless steel grid, wet odour trap.**

Flow of the inlet grid 46 l/min

Wet odour trap 51 mm

Resistance of odour trap against the pressure 480 Pa. Load class K3 300 kg. Waste pipe diameter 50 mm

Total installation height 79 – 189 mm.

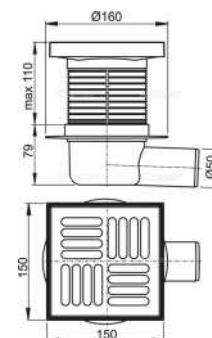

APV26

8595580503765

**Floor drain 105×105/50 mm side outlet, stainless steel
grid, wet odour trap**

Application: For the interior, where will be frequent use associated with the regular water runoff into the floor drain (bathrooms). For drainage of floor level showers. For wheel-chair access. Norms: EN 1253. Customs code- 39269097.

Technical parameters: Flow of the inlet grid- 32 l/min. Odour trap- 25 mm. Total installation height -77 – 113 mm. Waste pipe diameter- 50 mm. Load class K3 300 kg.

Specifications: Reduced installation height. Stainless steel grid 102×102×5 mm. Height adjustable throat 11–47 mm. Insulation collar for connection to waterproofing of the building. Side connection to waste Ø50 mm. Mechanically cleanable trap up to the waste pipe. Wet odour trap prevents the penetration of odours from the sewer.

Material: polypropylene resistant to mechanical, chemical and thermal damage. Material: stainless steel AISI 304, DIN 1.4301

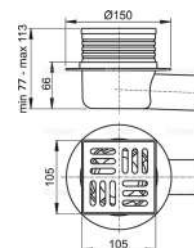

APV0010

8595580507473

WET ODOUR TRAP

Application: For floor drains, For interior use

Norms: EN 1253, Customs code: 39269097

Technical parameters: Flow rate 46 l/min, Resistance of odour trap against the pressure 480 Pa, Odour trap 51 mm

Specifications: Wet odour trap prevents the penetration of odours from the sewer

Material: polypropylene resistant to mechanical, chemical and thermal damage.

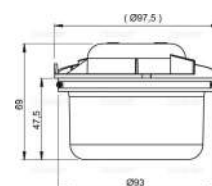

Description	Ref. nr.	Bar code	stock	
APZ12 Optimal Plastic linear shower drain for perforated grids or tile embedding +grid TILE + AP Flow rate 63-68.8L/min.	APZ12-850	8595580541040	4 PCS	
	TILE-850	8595580543006	4 PCS	
	APZ12-950	8595580541057		
	TILE-950	8595580543013		

Description	Ref. nr.	Bar code	
APZ12 Optimal Plastic linear shower drain for perforated grids or tile embedding +grid SOLID + AP Flow rate 63-68.8L/min.	APZ12-850	8595580541040	
	SOLID-850	8595580548803	
	APZ12-950	8595580541057	
	SOLID-950	8595580548810	
	APZ12-1050	8595580541064	
	SOLID-1050	8595580548827	

APZ12 Optimal

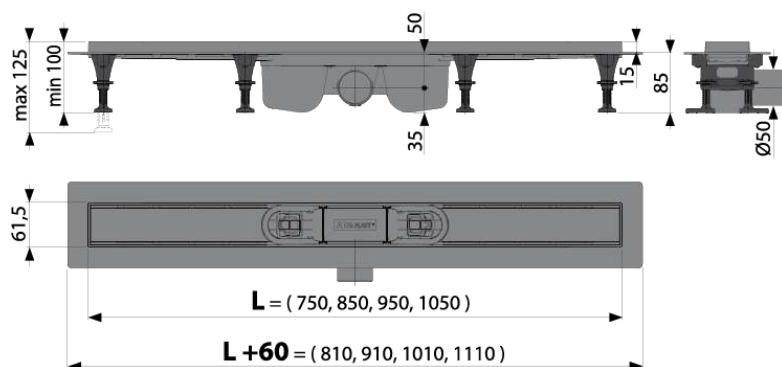
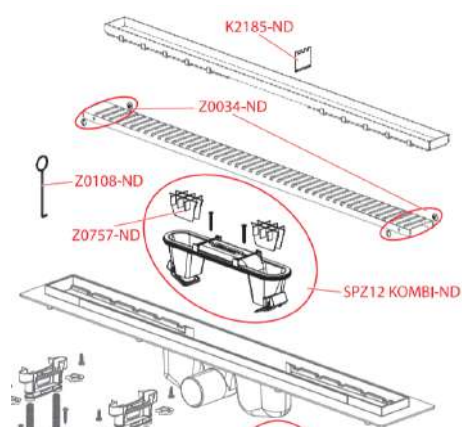

TILE

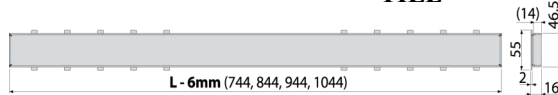

SOLID



Spare parts optional for APZ12 Optimal

SPZ12 KOMBI TRAP	SPZ12	
Z0757 Stainer	Z0757	
Spaces for Gird APZ12 (OPTION/SOLID/TILE)	Z1537	

Description	Ref. nr.	Bar code	stock	
APZ9 Simple	APZ9-750M	8595580504083	2 PCS	
Plastic linear shower drain with an edge for perforated grids (squares)	APZ9-850M	8595580504	2 PCS	
Flow rate 28L/min.	APZ9-950M	8595580504120	3 PCS	

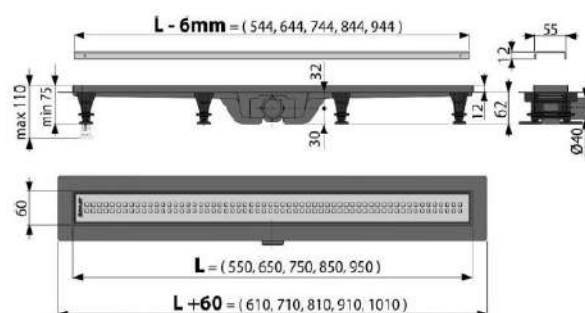

Description	Ref. nr.	Bar code	
Spare parts			
Grid for APZ10-550	Z0750-ND-550M		
odour trap for plastic shower drain APZ9/10	P065		
Sealing for trap P065	Z0234-ND		
Ball brushed	Z0216-ND		

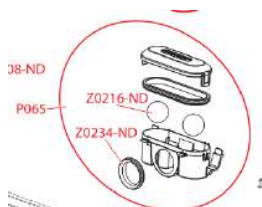

Z0234-ND



P065

σιφόνι smart για
υγρή και ξηρή
παγίδα μυρωδιάς!

Z0216-ND



Description	Ref. nr.	Bar code	stock	
APZ10BLACK Simple Plastic linear shower drain with an edge for perforated grids, black Flow rate 28L/min.	APZ10BLACK-650M		4 PCS	
	APZ10BLACK-750M	8595580570774	2 PCS	



APZ10BLACK Simple

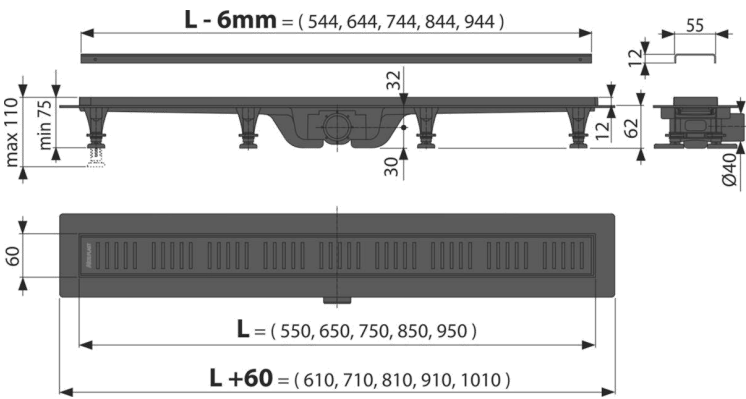

σιφόνι smart για γρήγη και
ξηρή παγίδα μυρωδιάς!

Description	Ref. nr.	Bar code	
APZ1 Stainless steel shower drain with an edge for perforated grids Flow rate 63-68.8L/min.	APZ1-650	8594045932928	
	LINE-650M	8594045932027	
	APZ1-850	8594045932942	
	LINE-850M	8594045932065	
	APZ1-950	8594045932959	
	LINE-950M	8594045932089	
	APZ1-1050		
	LINE-1050M	8594045932126	
	APZ1-1150	8594045939897	
	LINE-1150M	8594045939484	

Description	Ref. nr.	stock	
APZ1 Stainless steel shower drain with an edge for perforated grids Flow rate 63-68.8L/min.	APZ1-550	8594045939200	2 PCS
	PURE-550M	8594045939491	2 PCS
	APZ1-650	8594045932928	4 PCS
	PURE-650M	8594045932171	4 PCS
	APZ1-850	8594045932942	2 PCS
	PURE-850M	8594045932270	2 PCS
	APZ1-950	8594045932959	1 PCS
	PURE-950M	8594045932294	1 PCS
	APZ1-1050		1 PCS
	PURE-1050M	8594045932317	1 PCS
	APZ1-1150	8594045939897	1 PCS
	PURE-1150M	8594045939514	1 PCS



APZ1

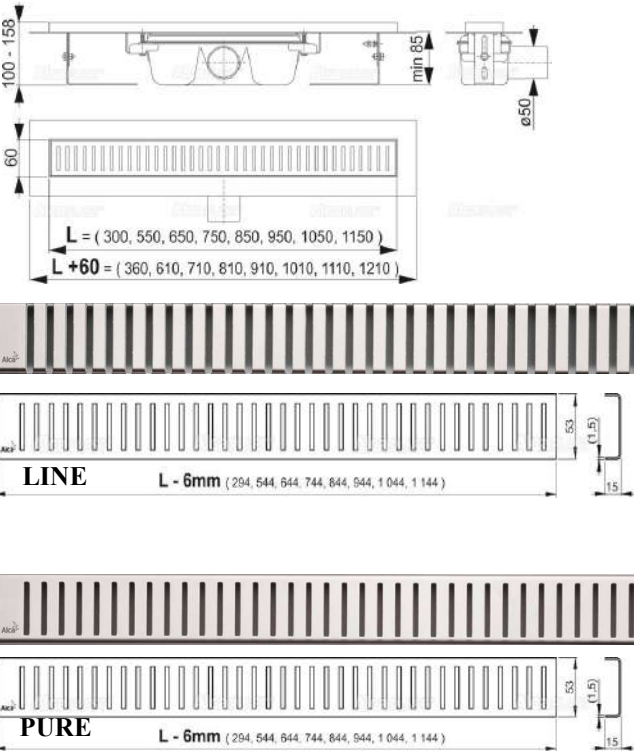

Description	Ref. nr.	Bar code	stock	
APZ1BLACK shower drain with an edge for perforated grids, black-matt	APZ1BLACK-550	8595580511883	2 PCS	
	PURE-550BLACK	8595580513344	2 PCS	
	APZ1BLACK-650	8595580512002	2 PCS	
	PURE-650BLACK	8595580513696	2 PCS	
	APZ1BLACK-750	8595580512293		
	PURE-750BLACK	8595580513887		



APZ1BLACK

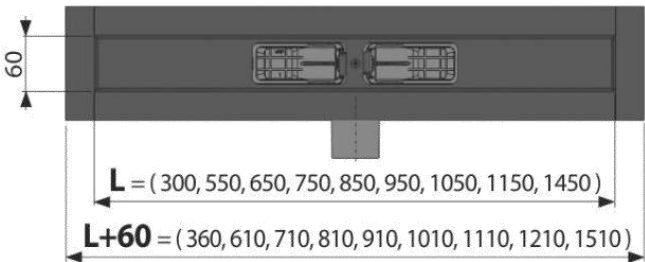
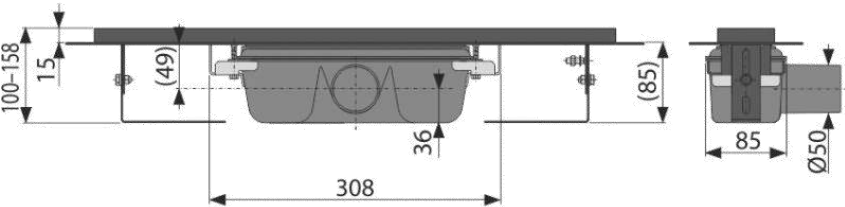

BLACK-MATT
WILL HIGHLIGHT
THE NEW LOOK
OF YOUR
BATHROOM

Shower drain APZ1BLACK
in black-matt finish

Our linear shower drains APZ1 and APZ101 are now available in the modern black-matt finish, supplemented by PURE BLACK grid. We always think about details, that is why the odour trap is black as well. It merges fully with the grid and the shower drain.

PURE-BLACK

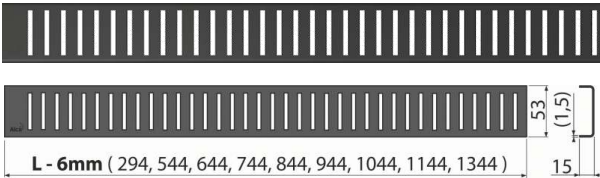

APV31BLACK

8595580574895

Floor drain 105×105/50 mm side outlet, stainless steel grid black-matt, combined odour trap SMART

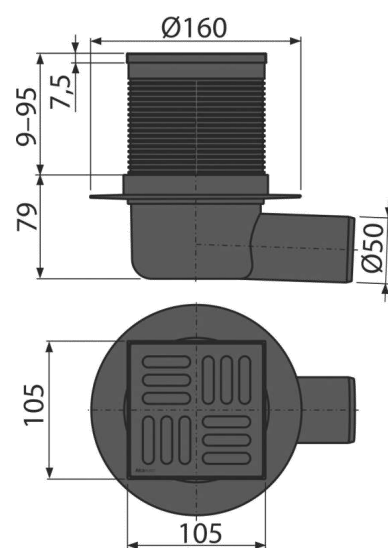

APV101

8594045930368

floor drain 105 × 105/50
side outlet, stainless steel grid, wet odour trap.

Packaging – outer box-8 pcs. Size – outer box-780×245×475 mm.

Weight – outer box- 8,2 kg. Load class (ČSN EN 1253- K3. Flow rate- 46 l/min.

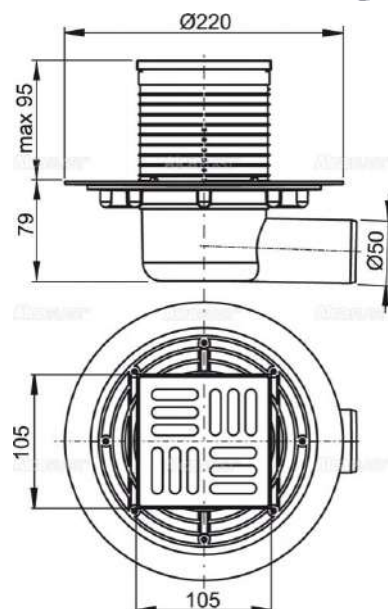

P138 DN50

8595580559854

**P142 DN40**

8595580560485

Spare parts optional for APZ2012 Optimal
extra-low trap dn40 for shower drains apz2012

**P184-ND**

8595580574390

Stainless steel grid (APZ2012, APZ2022)
SS Grid Hair Trap

